

LOCATION #32: FOREST MEADOW NTS  
LIMITS: EVERS TO STIRRUP  
LENGTH: 1,720 FEET

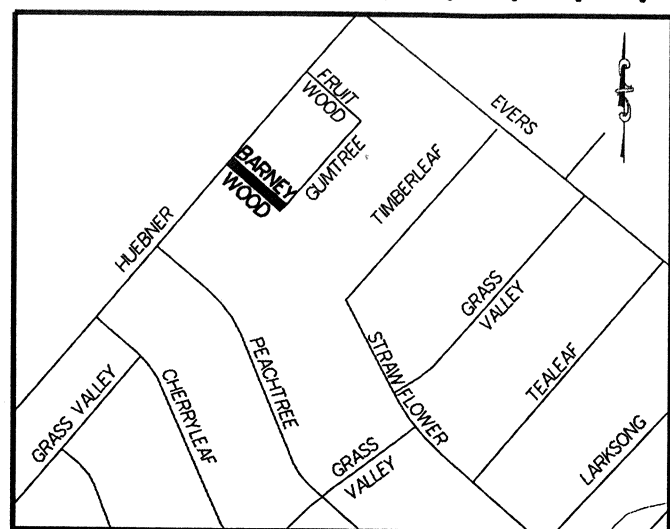

LOCATION #33: BARNEYWOOD NTS  
LIMITS: HUEBNER TO GUMTREE  
LENGTH: 200 FEET

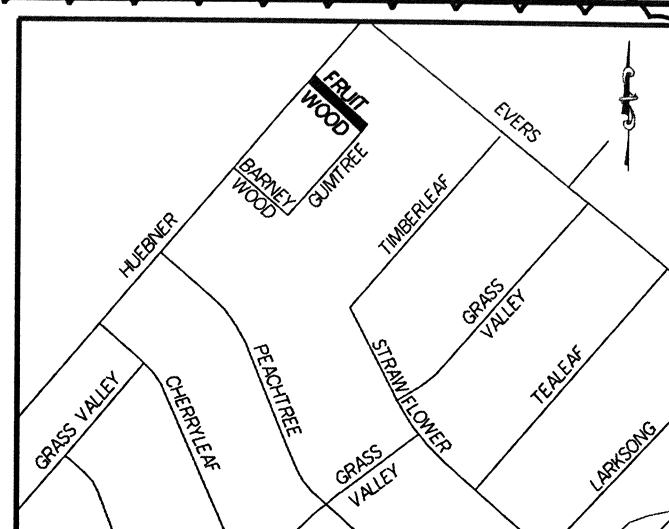

LOCATION #34: FRUITWOOD NTS  
LIMITS: GUMTREE TO HUEBNER  
LENGTH: 200 FEET

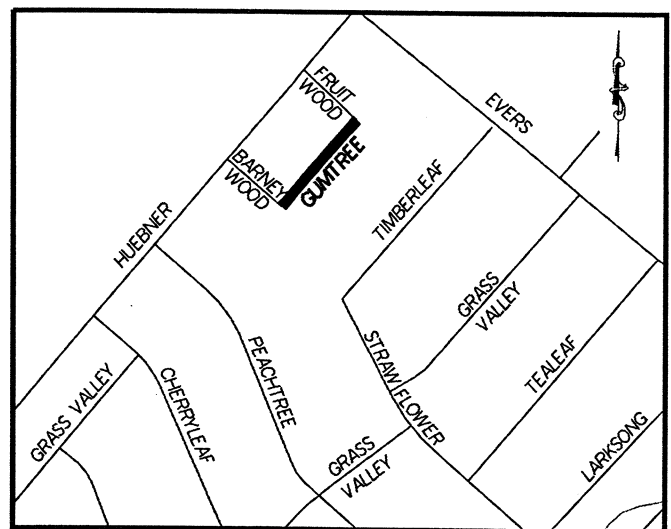

LOCATION #35: GUMTREE NTS  
LIMITS: BARNEYWOOD TO FRUITWOOD  
LENGTH: 400 FEET

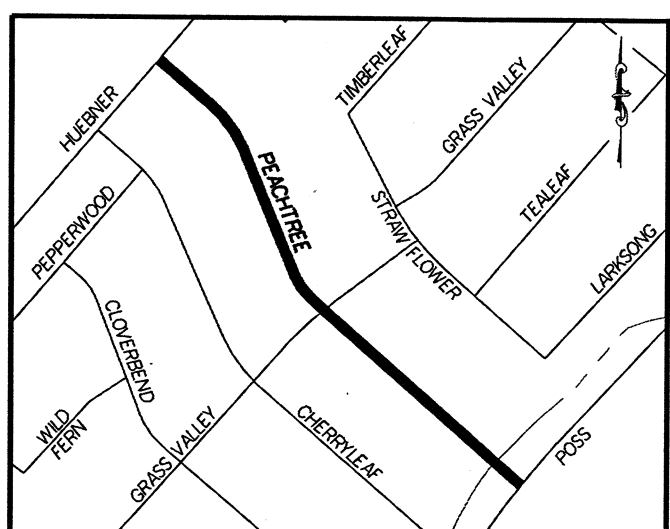

LOCATION #36: PEACHTREE NTS  
LIMITS: HUEBNER TO POSS  
LENGTH: 1,670 FEET

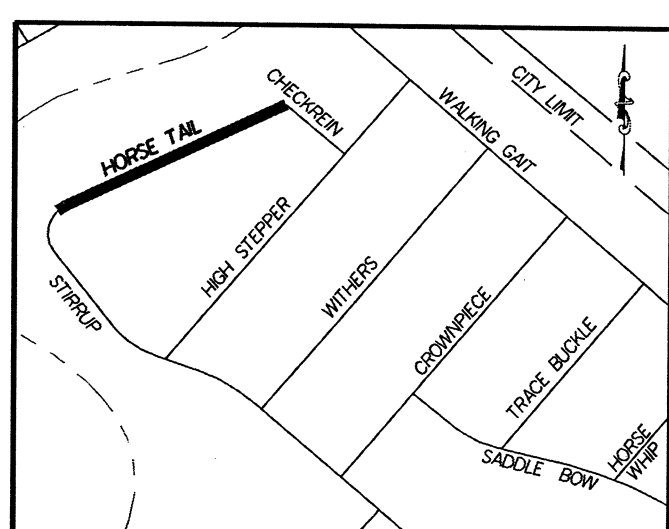

LOCATION #37: HORSETAIL NTS  
LIMITS: STIRRUP TO CHECKREIN  
LENGTH: 850 FEET

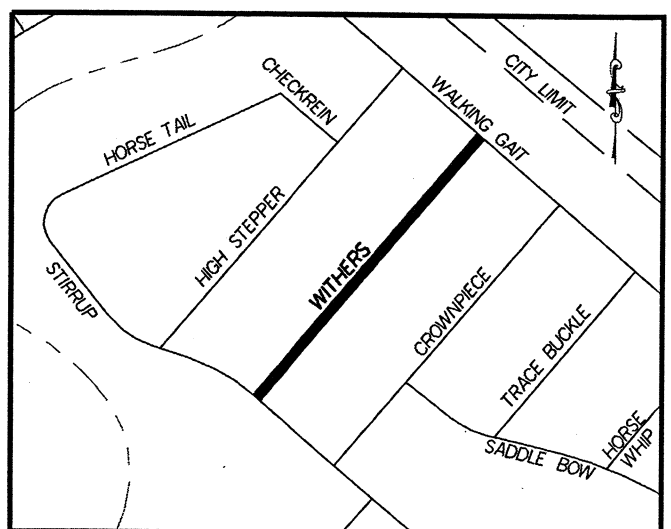

LOCATION #38: WHITHERS NTS  
LIMITS: STIRRUP TO WALKING GAIT  
LENGTH: 1,050 FEET

**LEGEND**

- CITY LIMITS
- CREEK
- SLURRY SEAL CONSTRUCTION LIMITS

1

The seal appearing on this document was authorized by  
EDWARD R. DE LA GARZA, P.E.  
on 2/25 2010

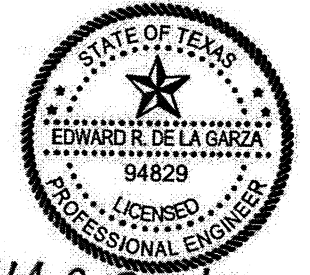

*Ed R. De La Garza, P.E.*

NO.	REVISION	BY	DATE
	ADDITIONAL LOCATIONS ADDED TO PROJECT.	ED	02.26.10

**GONZALEZ + DE LA GARZA & ASSOCIATES, L.L.C.**  
115 E. Travis St. Suite 640 San Antonio, TX 78205  
P: 210.208.9400 F: 210.208.9401  
TBE Firm # 10015



SLURRY SEAL  
2008-2009

LOCATION MAPS

SHEET 9 (7 OF 7)

K:\Leon Valley\Street+Maintenance\2009\Plans\Slurry Seal\LOCATION MAPS 7 NEW.dgn  
3/8/2010